



Light Weight HEAVY DUTY

- No need to notch joists.
- Quicker to install - can fit over the top of truss bottom chords.
- Lighter, less than 40% of the weight of traditional straps.
- CE Marked.
- 1.5mm thick.
- Formed edge design gives additional strength on bend.
- Complies with the BS EN 845.
- Easier to course with blockwork.



SIMPSON
Strong-Tie



Innovation Quality Service

For more information visit:
www.strongtie.co.uk/hes
or call 01827 255600

Simpson Strong-Tie
Winchester Road
Cardinal Point
Tamworth
Staffordshire
B78 3HG

Tel: 01827 255600
Fax: 01827 255616
Visit: www.strongtie.co.uk

S-HESBM02/08

SIMPSON
Strong-Tie

TOTAL RESTRAINT

No Holds Barred!

**HES and LES
Engineered Straps
From Simpson Strong-Tie**





HES and LES: Full Restraint - No Holds Barred.

Lean But Mean:

The “Engineered” Restraint Strap from Simpson Strong-Tie

We can prove that size doesn't matter, because even though our HES and LES engineered restraint straps are 40% lighter and thinner than conventional restraint straps, they out-perform them for structural strength and robustness.

They owe their performance and capacity to a unique design and 'engineered' strength - yet they are only 1.5mm thick.

Easier to handle due to their light weight, they take up less storage space and are simple to install - as the reduced thickness overcomes many fixing problems associated with heavier straps. For instance, you can span over the top of truss bottom chords and floor joists without the need for notching.

Being a Simpson Strong-Tie product you can take quality for granted, but you don't have to take our word for it - just check out the CE mark on every strap to be assured that while our engineered straps may look lean, they're seriously mean.



Suitable for Vertical and Horizontal Restraint Applications.

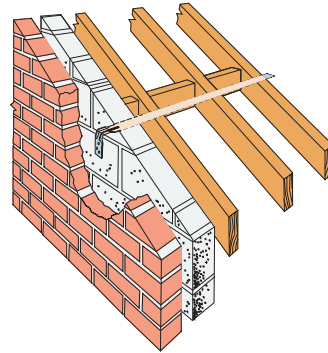

Roof Application:
HES strap fits underneath the rafter and noggins, as per NHBC/TRA detail.

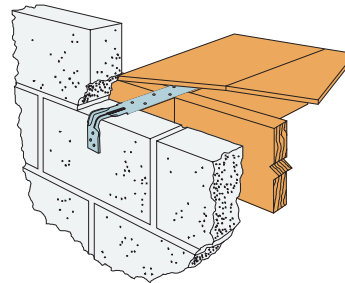

Floor Joist Application:
Fix HES strap using eight 3.75mm x 30mm square twist nails*.

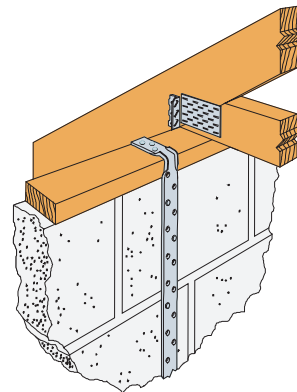

Vertical Application:
Fix LES strap to wall plate with 3 3.75 x 30 square twist nails. Fix LES strap to masonry with five 12mm x 50mm wood screws, plugged and screwed into masonry.

CE Marked and Compliant with BS EN845



Span 3 Trusses with a 1500mm Strap

The traditional heavy restraint straps require a 1600mm length to span three trusses, however the HES15B10 meets that requirement with a length of 1500mm.

That's one less strap size for you to keep on site.

Heavy Engineered Restraint Strap Sizes Available

Model No.	Dimension (mm)			Declared Load (kN)
	Thickness	Main Length	Bent Length	
HES06B10	1.5	600	100	8.0
HES08B10	1.5	800	100	8.0
HES10B10	1.5	1000	100	8.0
HES12B10	1.5	1200	100	8.0
HES15B10	1.5	1500	100	8.0

Light Engineered Restraint Strap Sizes Available

Model No.	Dimension (mm)			Declared Load (kN)
	Thickness	Main Length	Bent Length	
LES06B10	1.5	600	100	4.0
LES08B10	1.5	800	100	4.0
LES10B10	1.5	1000	100	4.0
LES12B10	1.5	1200	100	4.0

* Use Simpson Strong-Tie 3.75x30 Square Twist Nails, available in 1kg, 2.5kg and 5kg tubs.

